

TO LET

**Excellent Café / Retail Opportunity
Carrigaline, Co. Cork**



**Café / Retail Unit
66.3 Sq. M / 714 Sq. ft approx.**

Property Overview

- Superb Café/Retail unit extending approximately 66.3 Sq. M (714 Sq. ft)
- High profile position in the heart of Carrigaline with strong visibility
- Superior specification new build unit with extensive glazed frontage
- Excellent opportunity to trade alongside Aldi in a new purpose built scheme with on site customer car parking. Aldi Opening in Q4 2023
- Part of a larger significant town centre development with an indicative masterplan (not binding) that along with an Aldi store envisaged residential, commercial, Leisure and Drive Thru development over 5.21 acres

Contact

Philip Horgan
E: philip.horgan@cushwake.ie
T: 353 (0)87 969 1018

Peter O'Flynn
E: peter.oflynn@cushwake.ie
T: 353 (0)86 240 0153

Cushman & Wakefield
89/90 South Mall
Cork
Ireland
Tel: +353 (0)21 427 5454

cushmanwakefield.ie

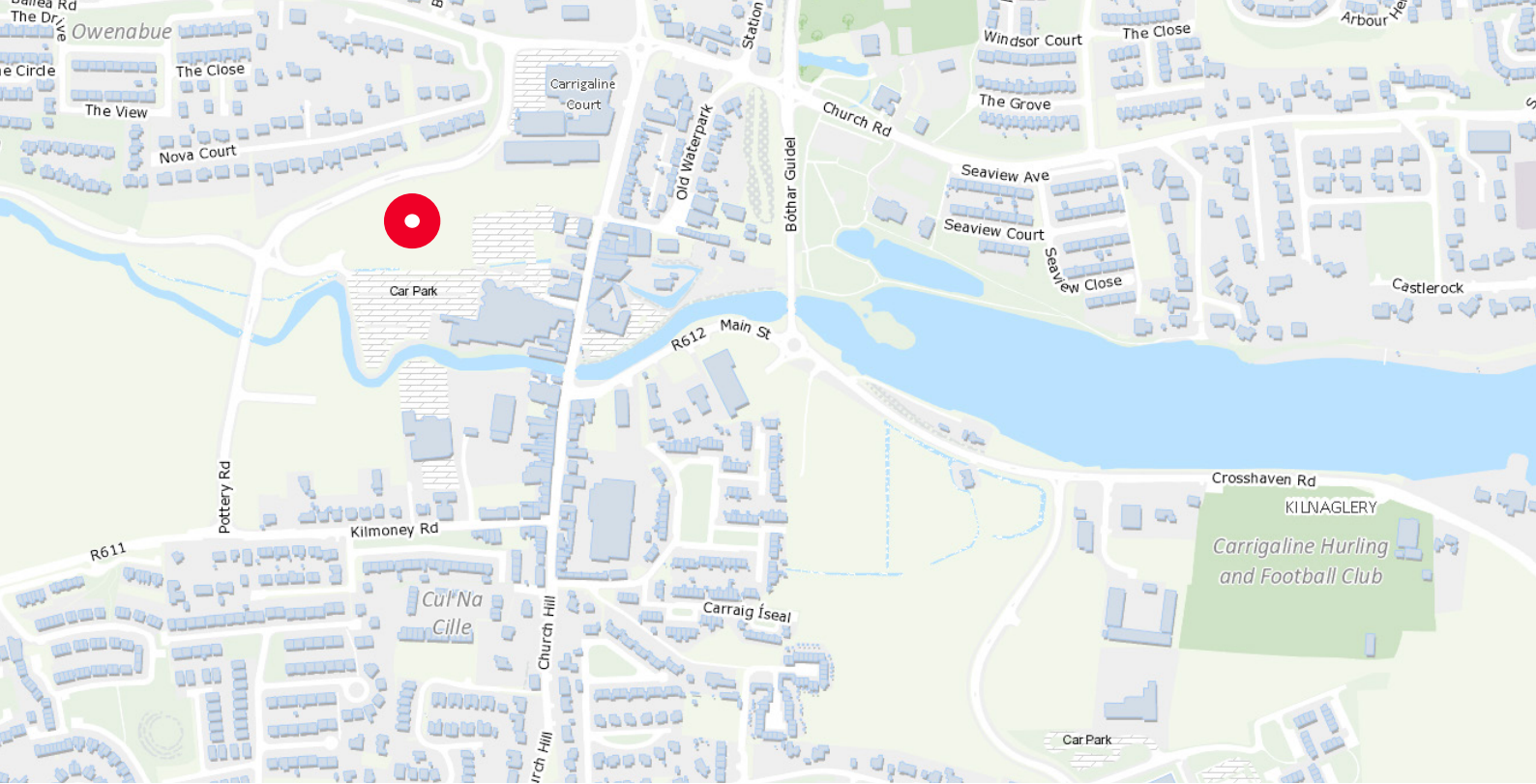

Location

Strategically located within a 2.10 Ha (5.21 Acres) site within an indicative masterplan for residential and commercial development. Town Centre location adjacent to local amenities including banks, shops & restaurants.

The subject property is situated between the Main Street and the new Western Relief Road adjacent to the new Aldi Supermarket.

Description

The property will comprise a single storey, modern café /retail unit with attractive glazed frontage and visibility to the centre car park and entrance. Regular shaped unit finished to shell & core specification.

Accommodation

66.3 Sq. M / 714 Sq. ft approx.

Lease Terms

Negotiable



Cushman & Wakefield
89/90 South Mall
Cork
Ireland
T: +353 (0)21 427 5454
E: corm@cushwake.ie

[cushmanwakefield.ie](https://www.cushmanwakefield.ie)

Guide Rent

On application.

BER details

BER details will be available on completion of building construction.

Viewing

View by appointment with the sole agents Cushman & Wakefield.

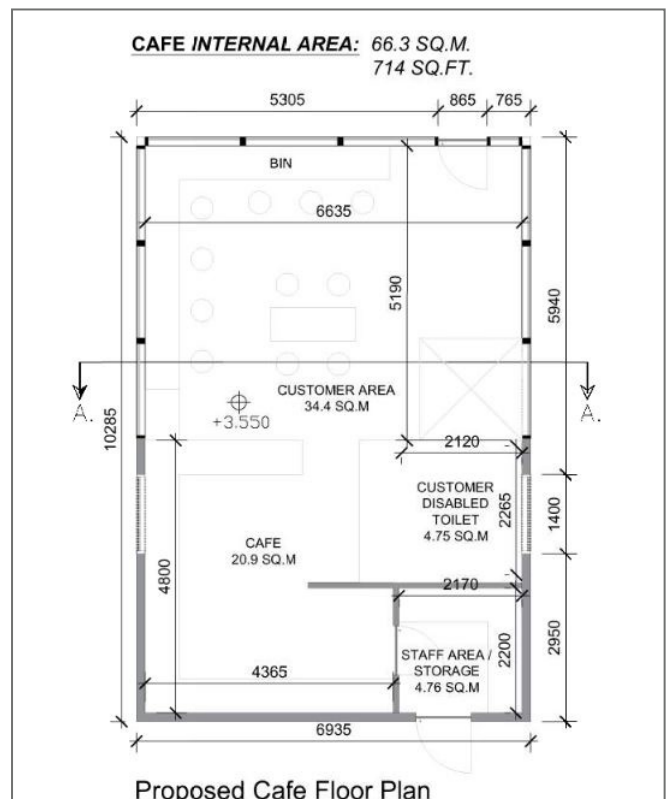

Conditions to be noted: A full copy of our general brochure conditions can be viewed on our website at <https://property.cushwake.ie/disclaimer>, or can be requested from your local Cushman & Wakefield office. We strongly recommend that you familiarise yourself with these general conditions. While care has been taken to ensure that information contained in Cushman & Wakefield publications is correct at the time of publication, changes in circumstances after the time of publication may impact on the accuracy of this information. PSRA Registration Number: 002607. OSI Licence No: CYAL50344545